



 **SolM** Building
a Healthier
Tomorrow

USA CATALOG **BLOOD COLLECTION DEVICES**



solm.com | info@solm.com

©2024 Sol-Millennium Medical Inc. All rights reserved.

Sol-Millennium is a vertically integrated medical supply company with locations across the globe. We are one of the world's largest manufacturers of needles and syringes and have a comprehensive line of medical supplies.

Our innovative technology reduces needlestick injuries, saves on medication expenses and enhances both clinician and patient experience. Our international sales team is dedicated to delivering knowledge and outstanding customer service. Our goal is to work together as partners in the healthcare industry, focusing on a healthier tomorrow.

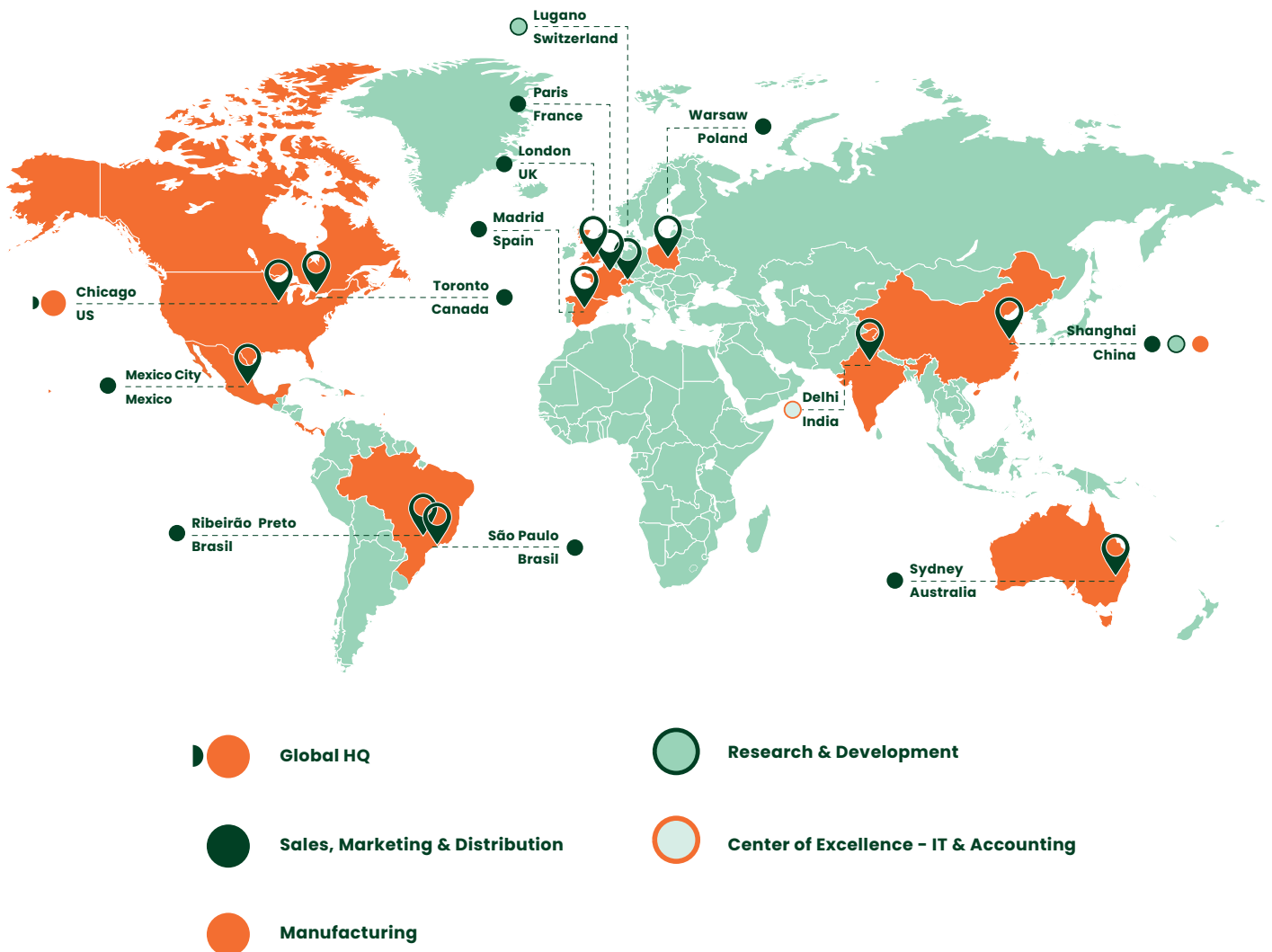

▶ Table of Contents



**Sol-Guard® Safety Pull-Button
Blood Collection Sets**

3-6



**Sol-Care® Safety Winged
Blood Collection Needles**

7-8



**Sol-Care® Safety Blood Collection
Tube Holder Set**

9-10



Sol-Care® Safety Multi-Sample Needle

11



Sol-M® Multi-Sample Needle

12



Sol-Care® Safety Lancets

13



Sol-Care® Safety Heel Lancets

14



**Accessories - Tube Holders, Luer
Adapter, Tourniquet**

15-17



Sol-Care® Alcohol Swabs

18



Sol-Guard®

Safety Pull-Button Blood Collection Sets



Sol-Guard® Safety Pull-Button Blood Collection Sets promote single-handed in-vein safety activation to instantly retract the needle after use, helping prevent needlestick injury and bloodborne pathogen exposure. With ease, safety and comfort in mind, this device features an exclusive version of the “Butterfly Needle”, designed with a sliding button that using pull force, activates in-vein needle retraction after use.

Features:

- Spring mechanism for split second in-vein needle retraction
- Large oversized arrow to easily identify the activation pull button
- Flashback for instant and clear confirmation of proper needle placement
- Low angled tri-bevel tip designed to improve penetration, while minimizing patient discomfort
- Thin-wall needle for fast flow rate and to reduce the risk of blood hemolysis
- Tactile non-slip grip to help engage the safety feature
- 30% wider wings for improved handling during insertion and removal



Available with or without pre-attached holder

Blood flashback and flow are easy to visualize

Sol-Guard® Safety Pull-Button Blood Collection Set with Pre-attached Holder

Sol-Guard® Safety Pull-Button Blood Collection Set

Providing a **Safe, Easy & Comfortable** Blood Collection Experience



88%

Reduction in needlestick injuries with in-vein needle retraction safety activation¹

2,000,000

Estimated number of needlestick and other sharps related injuries annually²

41%

of phlebotomist incur injuries from blood-draw procedures annually³



Before activation



After activation

Sol-Guard® Safety Pull-Button Blood Collection Sets

Reference number		Needle Inner diameter		Needle length		Tubing length	
with pre-attached holder	without pre-attached holder	Gauge	Millimeters	Inches	Millimeter	Inches	Millimeter
-	PBLA2107*	21G	0.69 mm	3/4"	19 mm	7"	178 mm
-	PBLA2307*	23G	0.53 mm	3/4"	19 mm	7"	178 mm
-	PBLA2507*	25G	0.38 mm	3/4"	19 mm	7"	178 mm
PBH2112	PBLA2112	21G	0.69 mm	3/4"	19 mm	12"	305 mm
PBH2312	PBLA2312	23G	0.53 mm	3/4"	19 mm	12"	305 mm
PBH2512	PBLA2512	25G	0.38 mm	3/4"	19 mm	12"	305 mm

Sales Unit With pre-attached holder: 25 pcs/Box; 200 pcs/Case
Without pre-attached holder: 50 pcs/Box; 200 pcs/Case

*Please contact your Sol M sales rep for more information on lead time for this product.



Sol - Guard[®]

XtraThin Safety Pull-Button Blood Collection Sets

Sol-Guard[®] XtraThin Safety Pull-Button Blood Collection Sets provide improved comfort, quicker procedure times and single-handed in-vein safety activation to instantly retract the needle after use, helping prevent needlestick injury and bloodborne pathogen exposure.

With ease, safety and comfort in mind, this device features an exclusive version of the "Butterfly Needle," designed with a sliding button that using pull force, activates in-vein needle retraction after use.

Features:

- XtraThin-wall needle for fast flow rate and to reduce the risk of blood hemolysis
- Large oversized arrow to easily identify the activation pull button
- Flashback for instant and clear confirmation of proper needle placement
- Low angled tri-bevel tip designed to improve penetration, while minimizing patient discomfort
- Spring mechanism for split second in-vein needle retraction
- Tactile non-slip grip to help engage the safety feature
- 30% wider wings for improved handling during insertion and removal



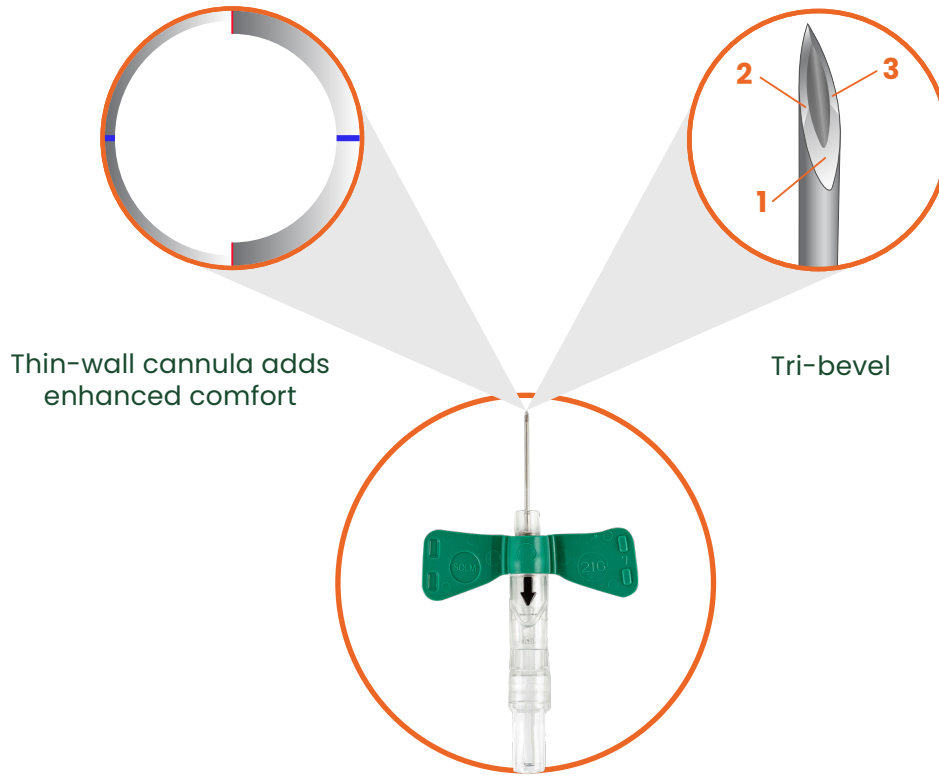

Sol-Guard® XtraThin Safety Pull-Button Blood Collection Sets (XtraThin-Wall)

Reference number		Needle inner diameter		Needle length		Tubing length	
with pre-attached holder	without pre-attached holder	Gauge	Millimeters	Inches	Millimeter	Inches	Millimeter
PBFH2112	PBFLA2112	21G	0.56 mm	3/4"	19 mm	12"	305 mm
PBFH2312	PBFLA2312	23G	0.38 mm	3/4"	19 mm	12"	305 mm
PBFH2512	PBFLA2512	25G	0.30 mm	3/4"	19 mm	12"	305 mm

Sales Unit With pre-attached holder: 25 pcs/Box; 200 pcs/Case
 Without pre-attached holder: 50 pcs/Box; 200 pcs/Case

Sol-Guard® XtraThin Safety Pull-Button IV Infusion Sets (XtraThin-Wall)

Reference number	Needle inner diameter		Needle length		Tubing length	
IV Infusion Sets	Gauge	Millimeters	Inches	Millimeter	Inches	Millimeter
PBNL2112	21G	0.56 mm	3/4"	19 mm	12"	305 mm
PBNL2312	23G	0.38 mm	3/4"	19 mm	12"	305 mm
PBNL2512	25G	0.30 mm	3/4"	19 mm	12"	305 mm

Sales Unit 25 pcs/Box; 200 pcs/Case



Sol-Care®

Safety Winged Blood Collection Needle



The Sol-Care® Safety Blood Collection Needle is a safety-engineered device with a sliding safety shield that clicks when activated, telling you the needle is safely locked.

Features:

- Transparent design that allows visualization of the blood flashback and flow
- Single-handed activation option that provides more flexibility to care for the patient and venipuncture site
- Sliding safety shield pushes over the needle and locks with an audible click, protecting against needlestick injury

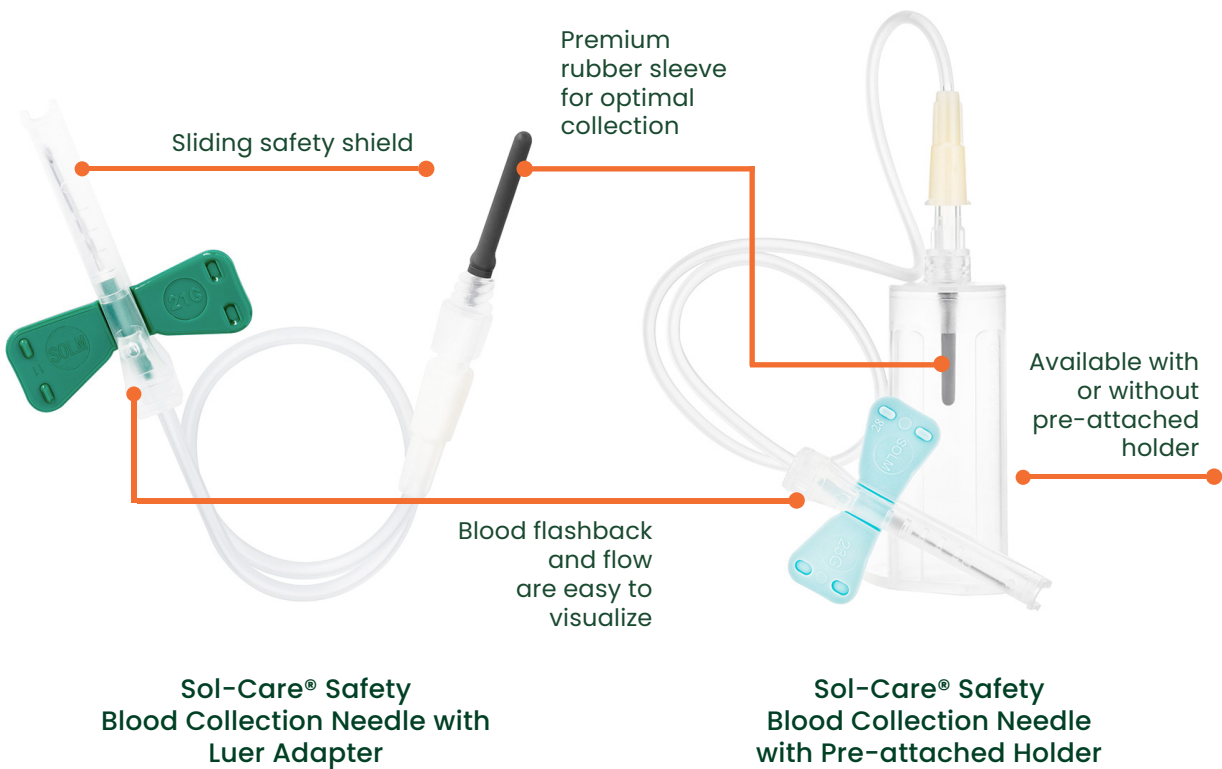

Sol-Care® Safety Winged Blood Collection Needle with Luer Adapter

Reference Number	Gauge	Needle Length	Tubing Length	Box Qty	Case Qty
SBCN2107	21G	3/4"	7"	50	200
SBCN2112	21G	3/4"	12"	50	200
SBCN2307	23G	3/4"	7"	50	200
SBCN2312	23G	3/4"	12"	50	200
SBCN2507	25G	3/4"	7"	50	200
SBCN2512	25G	3/4"	12"	50	200

Sol-Care® Safety Winged Blood Collection Needle with Pre-attached Holder

Reference Number	Gauge	Needle Length	Tubing Length	Box Qty	Case Qty
SBH2107	21G	3/4"	7"	25	200
SBH2112	21G	3/4"	12"	25	200
SBH2307	23G	3/4"	7"	25	200
SBH2312	23G	3/4"	12"	25	200
SBH2507	25G	3/4"	7"	25	200
SBH2512	25G	3/4"	12"	25	200





Sol-Care®

Safety Blood Collection Tube Holder Set

The Sol-Care® Safety Blood Collection Tube Holder Set is an innovative, exclusive blood collection safety accessory. The unique retraction mechanism is built into the special tube. After all specimens are drawn, the tube is pushed into the needle/hub assembly and withdraws the used needle, protecting the healthcare worker from any chance of accidental needlestick. This new safety device requires no additional movements or changes in technique. The activation is accomplished using the same forward pressure as is customary when using all other blood collection tubes.

Features:

- Totally passive as to hand repositioning; dominant hand continue to remain on last tube and behind the proximal end of tube holder
- Hands remain behind needle during the point of greatest potential hazard
- Safety mechanism is integral part of device and doesn't block sight of needle tip
- Complies with OSHA regulations to prevent cross-contamination
- Once captured, used blood collection needle is totally encapsulated within the yellow safety tube for disposal into sharps container

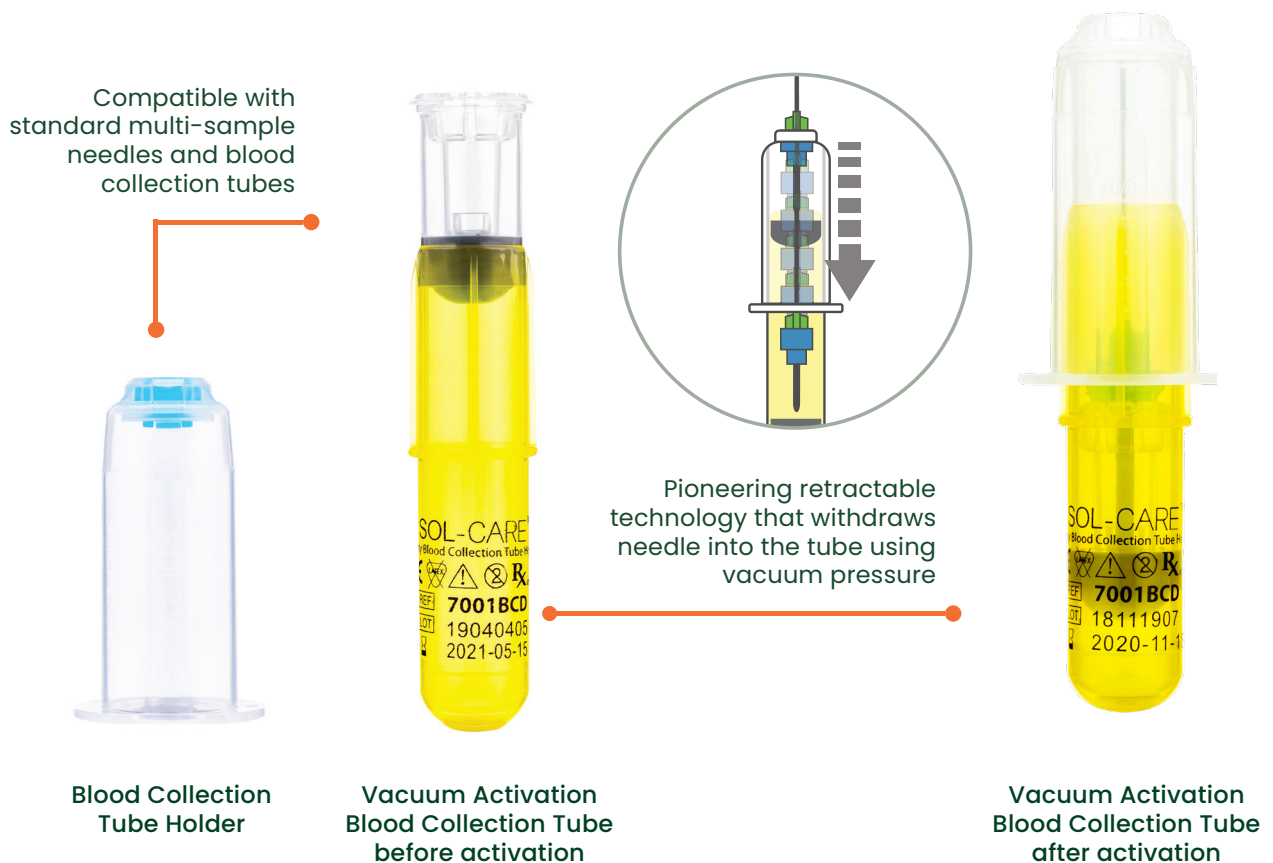



How to Use:

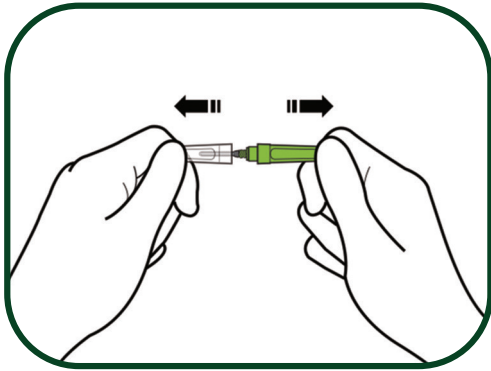

Step 1: Remove clear cap.

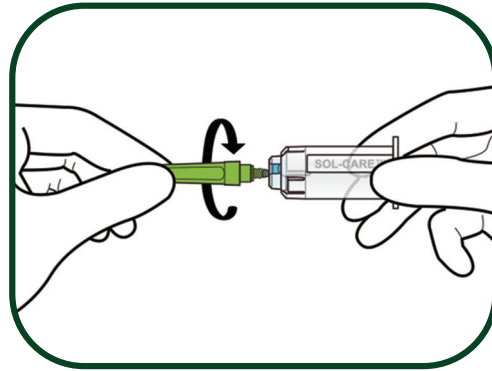

Step 2: Twist needle into tube holder.

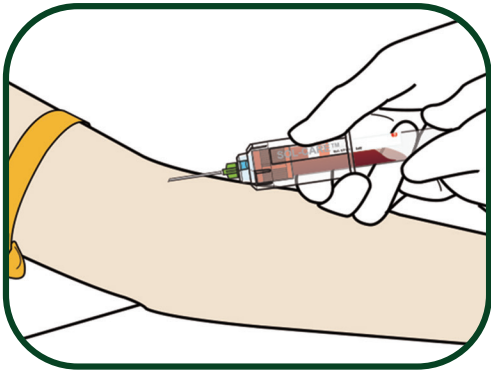

Step 3: Remove color-coded cap and insert the needle at a 30 degree angle, advance blood collection tube in the normal manner.

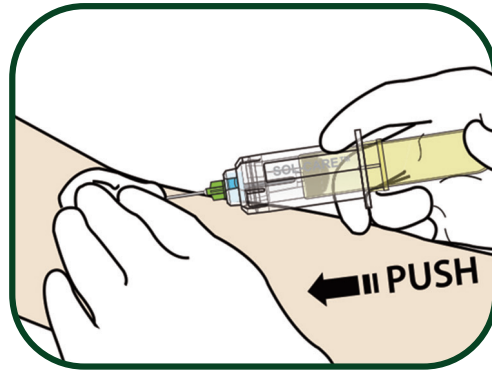

Step 4: After removing the final blood collection tube, advance the Vacuum Activation Blood Collection Tube and push forward using the same motion as with any blood collection tube.

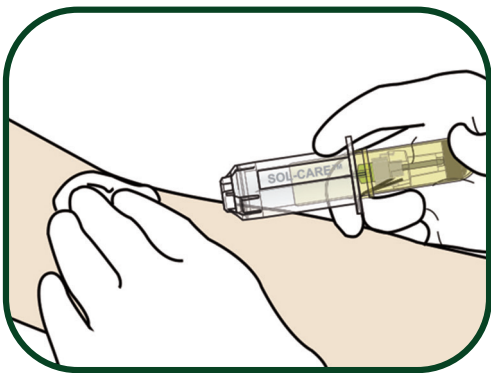

Step 5: Press to activate the vacuum retraction of the needle. The needle will withdraw into the tube holder. Apply pressure to the insertion site as per the normal procedure.

Sol-Care™ Safety Blood Collection Tube Holder Set

Reference Number	Box Qty	Case Qty
7001BCD	50	400

Sol-Care®

Safety Multi-Sample Needle



The Sol-Care® Safety Multi-Sample Blood Collection Needle is designed with a safety shield that completely covers and locks over the needle after use to protect against needlestick injuries.

Features:

- Safety shield aligns with a bevel up needle orientation, allowing for low-angle penetration
- Pivoting safety shield with audible click that indicates it is locked in place
- Safety mechanism is designed for one-handed activation
- Safety shield is color coded to reduce potential errors



Sol-Care® Safety Multi-Sample Needle

Reference Number	Gauge	Needle Length	Box Qty	Case Qty
SMSN21I25	21G	1 1/4"	48	480
SMSN22I25	22G	1 1/4"	48	480

Sol-Care® Safety Multi-Sample Needle with Pre-attached Holder

Reference Number	Gauge	Needle Length	Box Qty	Case Qty
SMSNH21I25	21G	1 1/4"	50	400
SMSNH22I25	22G	1 1/4"	50	400

Sol-M[®]

Multi-Sample Needle

- Black dot on multi-sample needle hub ensures bevel up orientation
- Low-angle bevel design allows easy penetration
- Color-coded caps and hubs allow easy identification of needle gauge size
- Compatible with all standard holders



Sol-M[®] Multi-Sample Needle

Reference Number	Gauge	Needle Length	Box Qty	Case Qty
110201020006	20G	1"	100	1,000
110201020007	20G	1 1/2"	100	1,000
110201020004	21G	1"	100	1,000
110201020005	21G	1 1/2"	100	1,000
110201020002	22G	1"	100	1,000
110201020003	22G	1 1/2"	100	1,000





Sol-Care[®] Safety Lancets

Sol-Millennium's Sol-Care™ Safety Lancets are designed for virtually painless testing.

Features:

- Pressure activated spring technology minimizes misfiring and gently controls penetration depth
- Needle retracts automatically and locks out for safety, protecting against accidental cuts and minimizing the chance of cross-contamination
- Easy twist-off cap removal
- Comfortable finger recess design
- Small contract face for precise puncturing

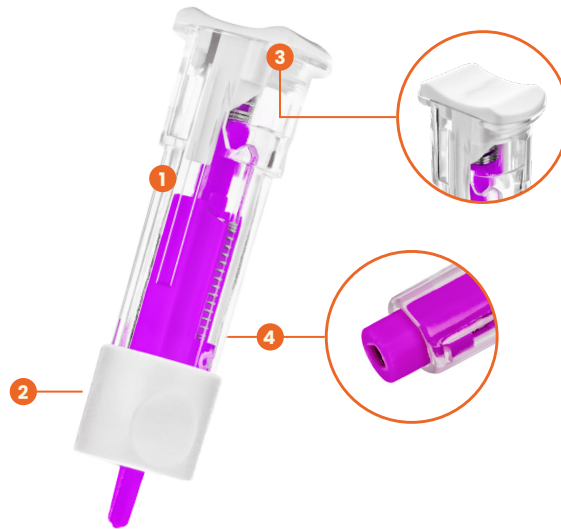

Sol-Care[®] Safety Lancet

Reference Number	Product Description	Needle Gauge	Needle Length	Blood Flow	Shelf Box/ Shipping Case (pcs)
SLA001	Sol-Care Safety Lancet 30Gx1.6mm	30G	1.6 mm	Ultra Low Flow	100/1000
SLA004	Sol-Care Safety Lancet 28Gx1.8mm	28G	1.8 mm	Low Flow	100/1000
SLA005	Sol-Care Safety Lancet 23Gx1.8mm	23G	1.8 mm	Medium Flow	100/1000
SLA008	Sol-Care Safety Lancet 21Gx1.8mm	21G	1.8 mm	High Flow	100/1000

Sol-Care®

Safety Heel Lancets

Sol-Millennium's Sol-Care™ Safety Heel Lancets are designed with a surgical grade blade, delivering a smooth, precise sweeping motion, that minimizes bruising and trauma during blood collection.

Ergonomic design offers multiple grip options, permits single handed activation, and reduces misfiring.

Features:

- Press trigger allows for one handed activation
- Visual indicator assists in puncture precision
- Unexposed blade prevents accidental needle stick injuries
- Safety stop prevents accidental misfiring

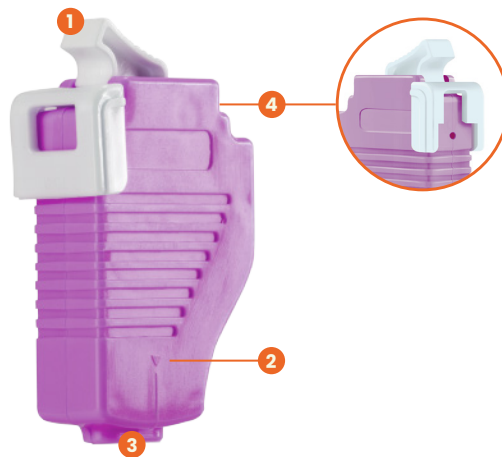

Sol-Care® Safety Heel Blood Lancet

Reference Number	Application	Incision Depth/Width	Color	Box Qty	Case Qty
LAH001	Micopreemie	0.65mm/1.5mm	Lavender	50	500
LAH002	Preemie	0.85mm/1.75mm	Green	50	500
LAH003	Newborn	1.0mm/2.5mm	Blue	50	500
LAH004	Newborn	1.5mm/3.0mm	Grey	50	500





Sol - M[®]

Blood Collection Tube Holder

For blood specimen collection and compatible with standard multi-sample needles.



Sol - M[®]

Blood Culture Holder

For blood culture collection and fits all standard evacuated blood culture bottles. Threads compatible with standard blood collection needles.



Sol - M[®]

Tube Holder with Luer Lock Adapter

For collecting specimens from IV lines or for urine specimens. Standard female Luer fitting. Compatible with IV sets, ports, and tubing according to ANSI standards.



Sol - M[®]

Blood Transfer Holder

For the transfer of blood from syringes to vacuum blood specimen tubes. Female Luer slip or Luer Lock compatible.



Sol - Care[®]

Safety Shield Blood Collection Tube Holder

For blood specimen collection and compatible with standard multi-sample needles. Features a pre-attached pivoting safety shield that allows the used needle to be fully covered after use to avoid needle-stick injuries.



Tube Holders

Reference Number	Description	Box Qty	Case Qty
110201050001	Sol-M Blood Collection Tube Holder	250	1,000
110201050002	Sol-M Blood Culture Holder	40	320
110201050003	Sol-M Tube Holder with Luer Lock Adapter	50	800
BCTH002	Sol-M Blood Transfer Holder	50	800
BCA019	Sol-Care Safety Shield Blood Collection Tube Holder	50	1,000



Sol - M[®]

Luer Adapter 20G

The Sol-M™ Luer Adapter is designed to work in a variety of functions by securely connecting to female Luer connections.

Features:

- An ideal accessory for use with blood collection sets that feature a holder for evacuated tubes
- Blue cap to differentiate from other blood collection devices for quick identification to reduce selection errors
- Designed to ensure secure connections and fitted with rubber sleeve to ensure no blood spills or exposure



Sol - M[®]

Latex-Free Tourniquet

Pre cut, latex free elastic tourniquet strips are packaged in an easy dispensing box that is convenient to use and store.

Features:

- Strong, durable, and elastic
- Textured surface
- Space saving, convenient packaging
- Not made with natural rubber latex



Other Accessories

Reference Number	Description	Box Qty	Case Qty
LA21920	Sol-M Luer Adapter 20G	100	1,000
TNQ002	Sol-M Latex-Free Tourniquet 1" x 18"	25	2,500

Sol - M[®]

Sterile Alcohol Swabs

70% isopropyl alcohol to clean and prepare the skin. Individually wrapped in 4-layer wrappers for an air-tight seal that prevents leakage and drying.

Features:

- 70% isopropyl alcohol
- Individually wrapped
- Durable wrapper

Alcohol Swabs

Ref. Number	Description	Size	Box	Case
SIA1001	Sterile Alcohol Swabs – 30mm x 30mm	Medium	100 pcs	10,000 pcs
SIA1002	Sterile Alcohol Swabs – 85mm x 45mm	Large	100 pcs	1,000 pcs





Individually wrapped in multiple sizes.





For more information contact us at:

 311 South Wacker Dr
Suite 4100
Chicago IL 60606

 833.637.0857

@ info@solm.com

Visit us at:

solm.com



NACA-MTP-383-1023

©2024 Sol-Millennium Medical Inc. All rights reserved.